

**Safety:** 1) Always check for power lines before digging.  
2) Always wear safety glasses when operating power equipment.

**Tips :** 1) Substructure should be plumbed and square.  
2) Joists should be spaced to a maximum of 24" on center.  
3) Maximum coverage of each board is 5 15/16".  
4) Overhang deck boards to a maximum of 4".  
5) Use #8 x 2" SS pan head screws with square drive for securing deck.

**Step 2)** Cut deck plank to desired length. Drill an access hole through the top surface only. (Starter plank only) Screw the bottom to joist through the access hole. (Fig. 2) Be sure to start this plank straight! **Do not over tighten screws. Set torque on screw gun properly.**

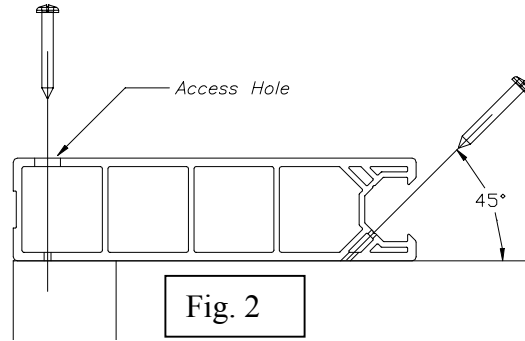

**Step 1)** Remove tongue from starter piece. This can be done with a circular or table saw. (Fig. 1)

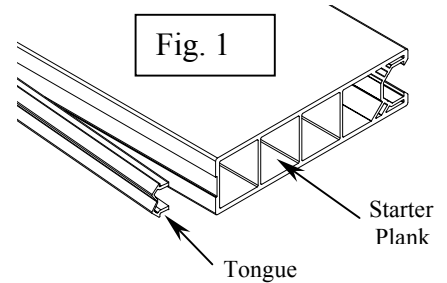

**Step 3)** Secure opposing edge of plank to joist as shown, one screw at the intersection of each stringer. Make sure to start screw tip in the locating groove. Maintain 45-degree angle when driving screws. (Fig. 2)

**Step 4)** Cut next deck plank to desired length. Slide tongue under top lip and snap into place. (Fig. 3)

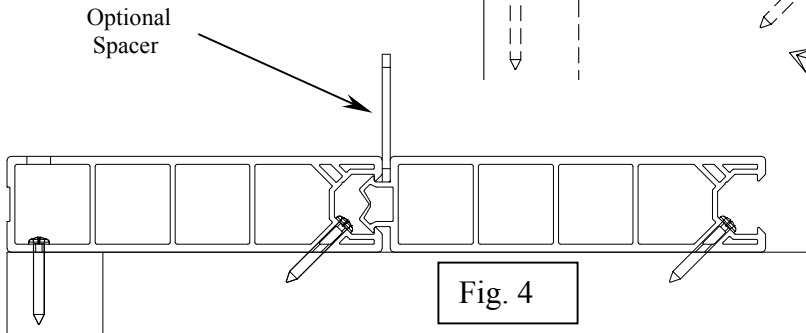
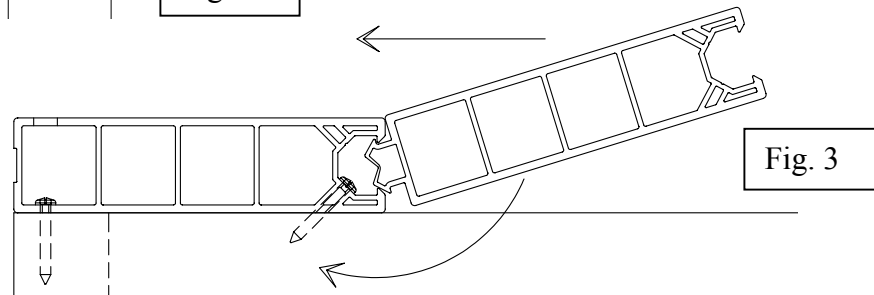

**Step 5)** Secure edge of deck board to joist as in step #3. (Open groove side only!) (Fig. 4) If a gap is desired, use a spacer between deck boards at each screw location to maintain the gap between the deck boards. Repeat this process until all of the deck boards are installed. Last deck board may be cut down to desired width. When removing open groove side of deck board, secure deck plank to joists as in step #2. (Fig. #5)

**Step 6)** Finish by trimming out the deck edges with "L" Trim and "C" Channel. Use "L" Trim for flush edges and "C" Channel for overhangs. Secure trim pieces with pushpins every 16". Drill 1/4" hole through trim pieces and deck board and secure by pressing pushpin in place.

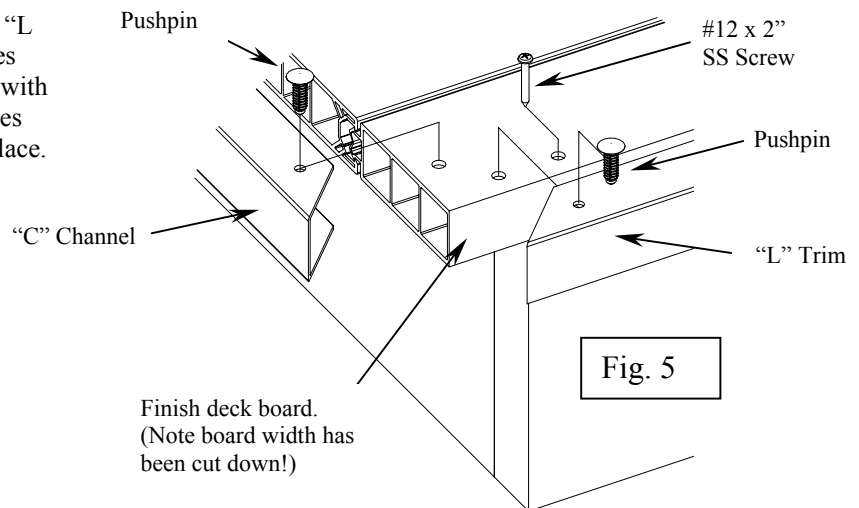

Refer to our catalog for other trim options available for your deck.

**Care and Cleaning** —Ordinary dirt and mud usually washes off with a hose. At times it may be necessary to use a non-abrasive household cleaner to remove residue and then rinse with a hose.

Royal Crown Limited  
PO Box 360  
Milford, IN 46542-0360  
Phone 800-365-3625  
Fax 574-658-3147

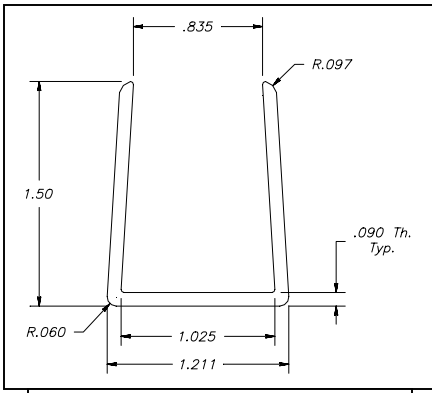

F\*39108 1" C-Channel

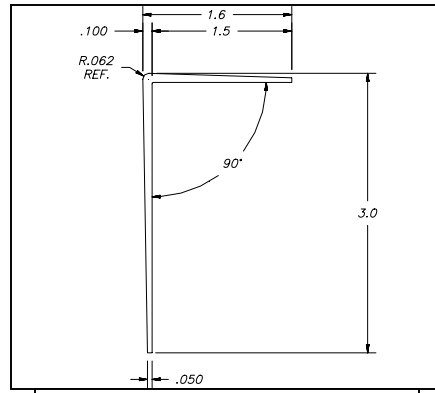

D\*80752 L-Trim

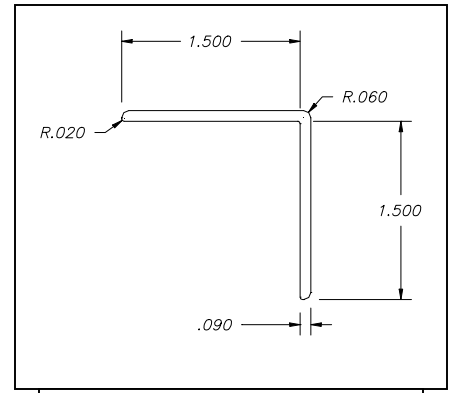

R\*1171 L-Trim

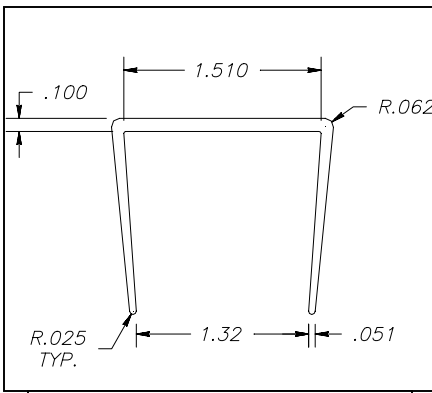

D\*80892 1.5" C-Channel

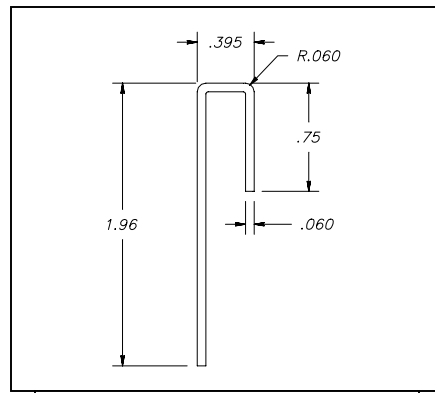

D\*42603 J-Channel

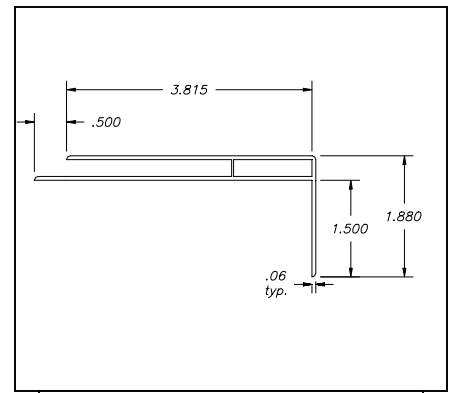

D\*42604 Extended "J"

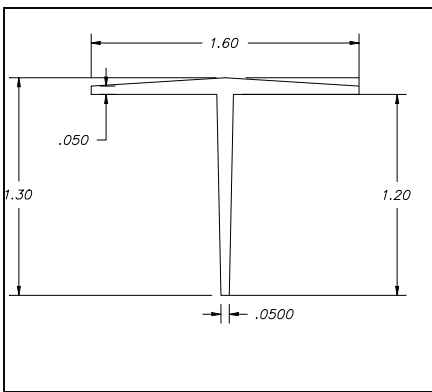

D\*80751 T-Strip

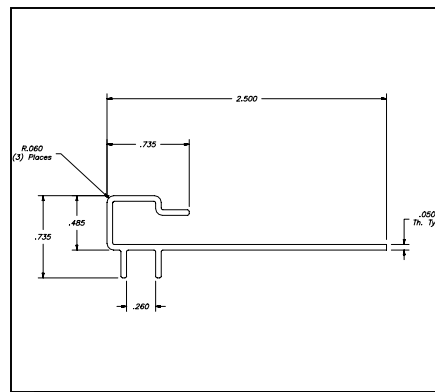

D\*42484 Corner Splicer

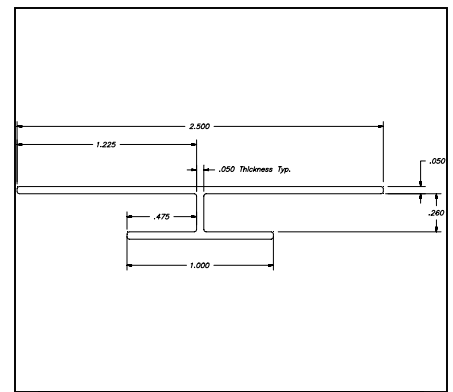

D\*42484 Corner Splicer

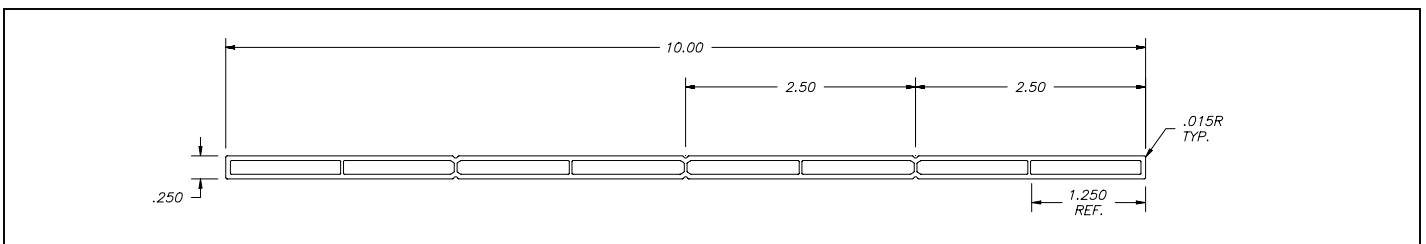

D\*42438 1/4" x 10" Fascia